

Up
Down River begin. at W.O.
1 N 4 E 33
2 N 20 1/2 E 20
3 N 33 E 34
4 N 39 E 10 to Sassafras
97 perches

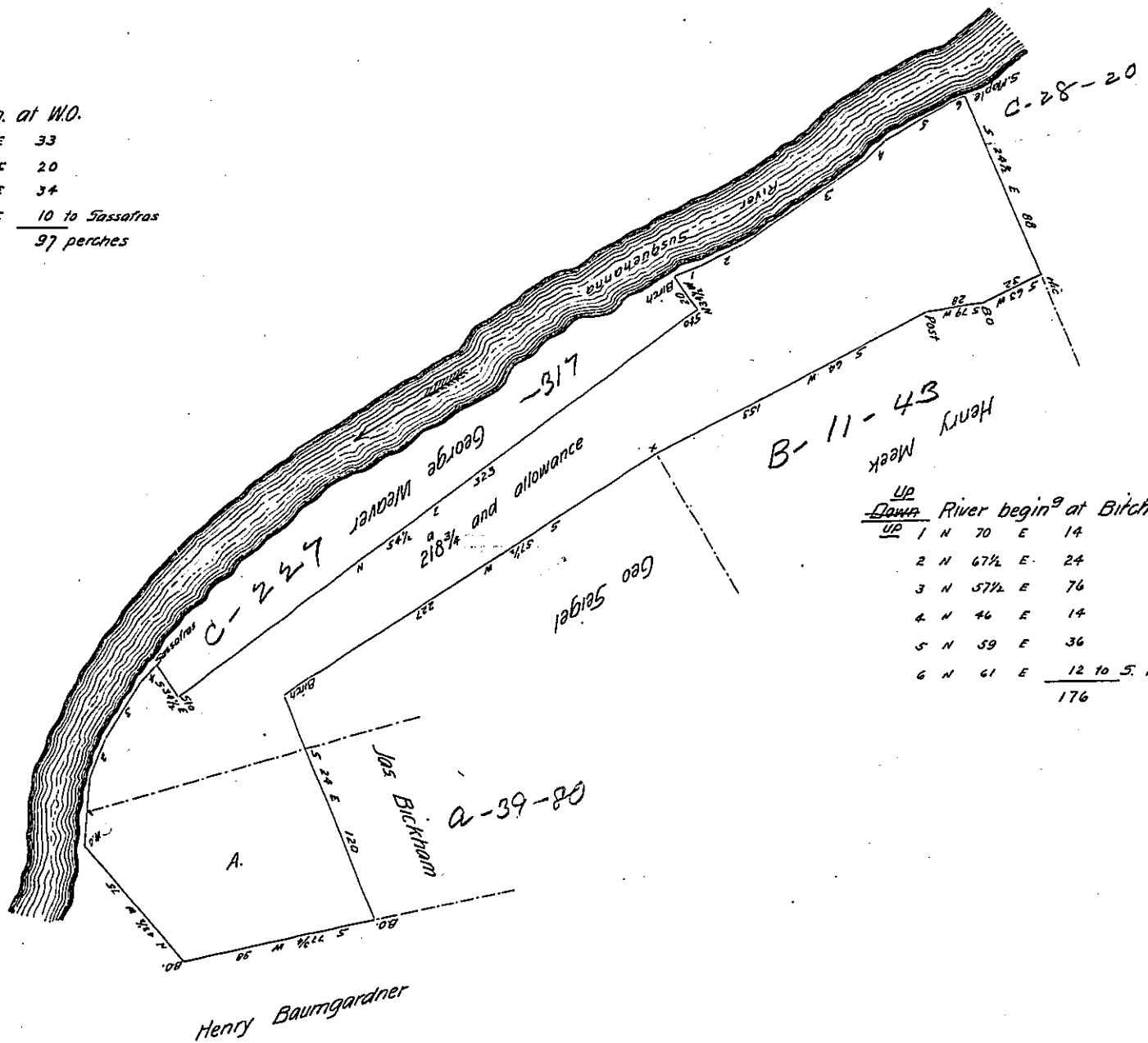

Up
Down River begin^d at Birch
1 N 70 E 14
2 N 67 1/2 E 24
3 N 57 1/2 E 76
4 N 46 E 14
5 N 59 E 36
6 N 61 E 12 to S. Maple
176

Surveyed on the 20th & 21st of April 1830 for Henry Deedy pursuant to his Warrant of the 31st of May 1813. Situate in Upper Paxton Township Dauphin County Containing two hundred eighteen acres three quarters and allowance of six per cent for roads &c.

John Davies D. S.

To Jacob Spangler Esq.
Surveyor General.

Note, The part marked A is said to be claimed by the heirs of James Bickham dec^d

J. Davies

IN TESTIMONY that the above is a copy of the original remaining on file in the Department of Internal Affairs of Pennsylvania, made conformably to an Act of Assembly approved the 16th day of February, 1833, I have hereunto set my Hand and caused the Seal of said Department to be affixed at Harrisburg, this

twenty ninth day of September 1905

Geo. D. Brown
Secretary of Internal Affairs.